

INSTALLATION OPTIONS:

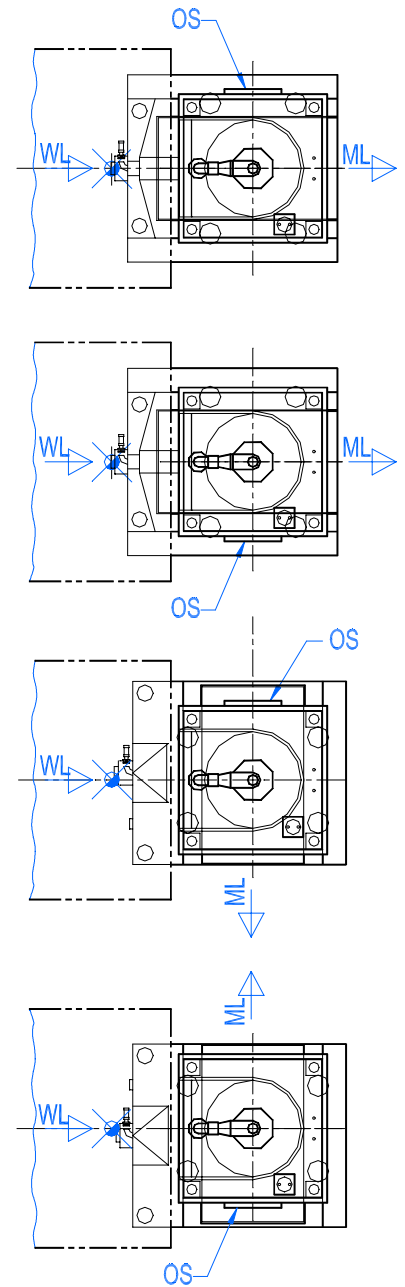

- WL = Wet Linen
- ML = Moist Linen
- E = Electric Supply
- WR = Water Recovery DN 50
- WO = Water Overflow DN 125
- WD = Water Drainage DN 125
- OS = Operation Side

- D = Floor Drain
- CW = Cooling Water in/out R3/4"
- A = Compressed Air DN 6

Foundation Load Each Leg  
= 2105 kg

Entrance Dimensions:  
Height = 2400 mm  
Width = 1500 mm

Recommended minimum wall  
clearance = 900 mm

Subject to alterations

# LAVAPRESS

# LP 571-50

## SPECIFICATIONS

Capacity - dry weight, cotton up to	60 kg
Batch diameter ( nominal )	940 mm
Cycle time min.	75 sec
Moisture retention ( DIN 11901 ) as per operating conditions	48 - 54 %
Electrical: connected load 8,7 kW	consumption approx. 6,3 kWh
12,2 kW with periods shorter than 2 min. resp. 60 cycles	9,3 kWh
Cooling water, utilized in the batch washer approx.	350 l/h
Compressed air : 6 bar, suction capacity	approx. 2 l/shift
Entrance dimensions, machine lowered, hydraulics not disconnected	W = 1500 mm, H = 2400 mm
Operational dimensions:	length 2060 mm, width 1840 mm, height 3270 mm
Operational weight	approx. 8500 kg
Transport weight	gross 8500 kg

## APPLICATION

The **Lavapress LP 571** is a single stage press for cyclic extraction of processed laundry batches consisting of 0 - 50 kg dry weight, transferred from the batch washer.

## EXTRACTION

Even and consistent with a controlled pressure build up, using a water filled membrane pad mounted to the press stamp, that prevents damage to the laundry.

## STANDARD VERSION

Solid steel construction consisting of a base section, columns and a head section.

Oil hydraulic with oil cooling and 200 litre filling

3 selectable pressure stages, e.g. 12, 18, max. 30 bar

Pressure shut-off each pressure stage possible

1 replacement pressure pad

In line, left or right angle installation is available

Chute for **LAVATEC** batch washer

Electric supply: 3/N ~ 50 Hz, 400 / 230 V

Microprocessor control with operating display and manual control.

Laundry contact only with stainless steel parts.

Machine panelling made of stainless steel, wire-brushed-finish.

Large maintenance doors on two sides of machine.

Large water collection tank with pump device and drain connection.

Transport conveyor with drainage plate for safe batch transport from the press.

Pedestal for height adjustment.

Machine equipped in accordance with relevant safety standards.

## SPECIAL VERSION

Programmable pressure control

Chutes for selected batch washers or customized installation

Chute additionally equipped with closing device.

Conveyor extension + 600 mm.

Conveyor - special length compensation by intermediate conveyor.

Special basket - height increase + 60 mm.

Electrical: special voltage, special frequency, CSA -, Nema/UL-regulation.

Special finish.

## ACCESSORIES

Transport units for batch transfer