

# Lavatec TT733D

## 50kg steam tumble dryer

### TT733D

A high performance automatic batch tumble dryer. Loading through a large front door with air assisted discharge at the rear. Efficient radial and axial airflow with options for automatic lint collection. Available with tilting to help unloading and infra-red drying control.

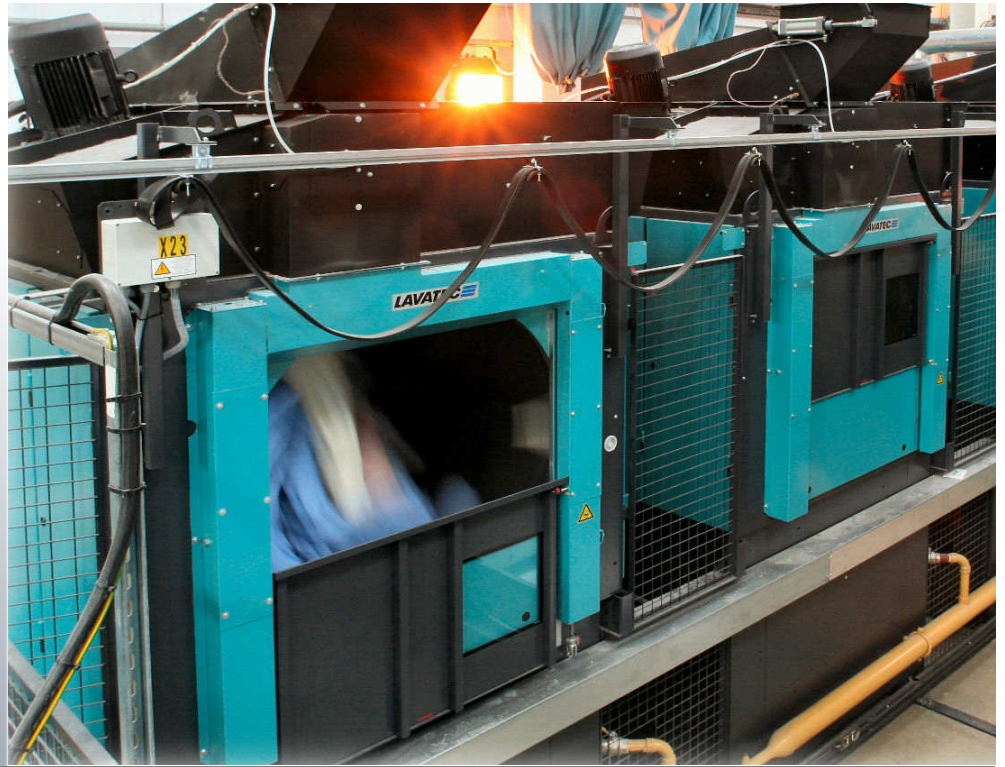

### FEATURES

Microprocessor control

Energy efficient

Large loading ratio

Heavy duty construction

Heating options

Lint collection options

Large simple interface, 99 drying programs, interfaces with most washing systems

Low running and maintenance costs, options for high efficiency LoNox burner

Large volume drum for excellent tumbling action

Very heavy construction, suitable for dustmats and the heaviest of duty cycles

Steam, thermal fluid oil or hot water

Std. Automatic collection in base of each dryer

Option of lint collection in the side of each dryer

Option of central lint collection from several dryers to one point

#### Thomas Broadbent & Sons Ltd.

Queen Street South  
Huddersfield, England  
HDI 3EA

Tel: +44 (0)1484 477200

Fax: +44 (0)1484 516142

E-mail: [bls@broadbent.co.uk](mailto:bls@broadbent.co.uk)

[www.broadbent.co.uk](http://www.broadbent.co.uk)

# Technical Data

## Lavatec TT733D

### Connected loads & consumption

	Consump'n	Conn. load
Electric	6.1kWh	7.2kW
Steam 10bar	225kg/hr	295kg/hr
Oil @ 180°C	6000l/hr	6000l/hr
Nom heating	130kW	
Pneumatic	200l/hr	250l/hr
Exhaust air	1300m <sup>3</sup> /hr	5000m <sup>3</sup> /hr

### Packing dimensions

Width	2200mm
Height	2500mm
Depth	2050mm

### Connection details

	Key	Size
Pneumatic	A	DN6
Exhaust	EX	DN400
Electric	E	
Steam	S	DN40
Condensate	C	DN25

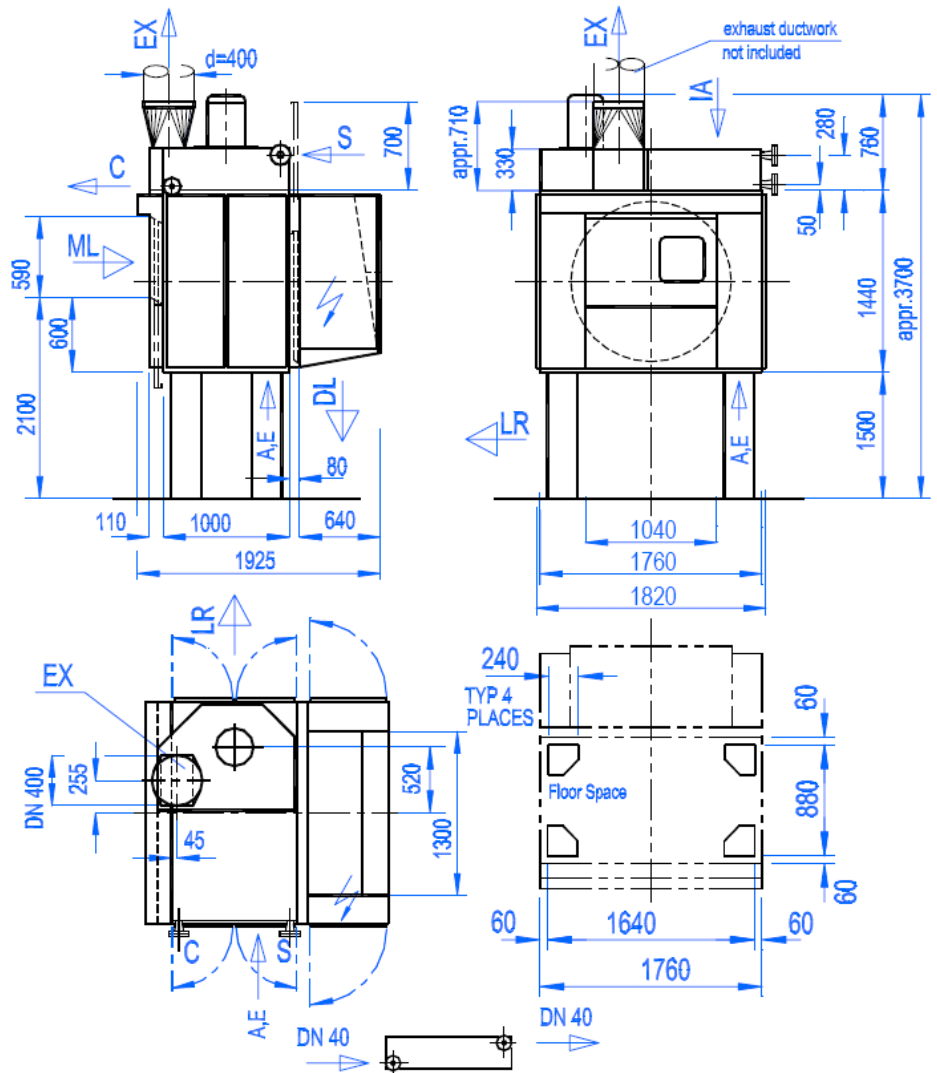

**Drum volume**

**1260 litres**

**Loading capacity**

**63kg @ 1:20    50kg @ 1:25    42kg @ 1:30**

**Weight**

**Net 1500kg    Operational 1600kg**

**Heating options**

**Steam 10 Bar    Thermal fluid @ 180°C    Optional double battery**

**Thomas Broadbent & Sons Ltd.**

Queen Street South  
Huddersfield, England  
HDI 3EA

Tel: +44 (0)1484 477200

Fax: +44 (0)1484 516142

E-mail: [bls@broadbent.co.uk](mailto:bls@broadbent.co.uk)

[www.broadbent.co.uk](http://www.broadbent.co.uk)